



## SEALING PLUGS

### SERIES SK 550

One piece construction  
Ideal for automated high production requirements

#### Material

Sleeve: Case Hardening Steel, Gun metal-finish  
Mandrel: Heat treatable steel, Special oil film lubrication

### KOENIG-EXPANDER®

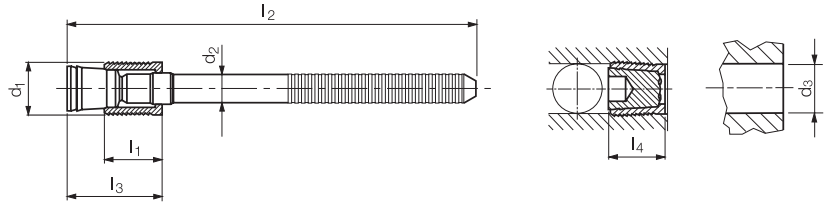

**Important:** See installation instruction on page 96  
**Installation requirements on pages 100–106**

**3D DATA:** <http://kvt.partcommunity.com>

Part Number	d <sub>1</sub>	l <sub>1</sub>	d <sub>2</sub>	l <sub>2</sub>	l <sub>3</sub> max.	l <sub>4</sub> max.	d <sub>3</sub> +0.12 0	Packaging Unit	
SK550-040	4,0	4,5	2,50	39	9,0	6,5	4,0	100	1000
SK550-050	5,0	5,5	3,00	41	10,0	7,5	5,0	100	1000
SK550-060	6,0	6,5	3,40	43	12,0	8,0	6,0	100	500
SK550-070	7,0	7,5	4,10	38	14,0	9,0	7,0	100	500
SK550-080	8,0	8,5	4,20	40	15,0	10,5	8,0	100	500
SK550-090	9,0	9,5	4,50	43	17,0	11,0	9,0	100	250
SK550-100	10,0	10,5	4,75	45	19,0	12,5	10,0	100	250

Dimensions in millimeters

Series SK mm	Base material of the Installation						
	①	②	③	④	⑤	⑥	⑦
	ETG-100 / 44SMn28 AISI 1144	C15Pb 1.0403	EN-GJL-250 EN 1561	EN-GJS-500-7 EN 1563	AlCu4Mg1 EN AW-2024-T3	AiMgSiPb EN AW-6012-T6	G-AiSi7Mg EN AC-42100
Ø 4 – 10	1.600 bar / 23.200 psi 500 bar / 7.200 psi					1.400 bar / 20.300 psi 450 bar / 6.500 psi	

Proof Pressure Test ②

Max. allowable Working Pressure = Nominal Pressure